

Patch Panel STP Cat6

Model: LP-PP-CS-6A-48P

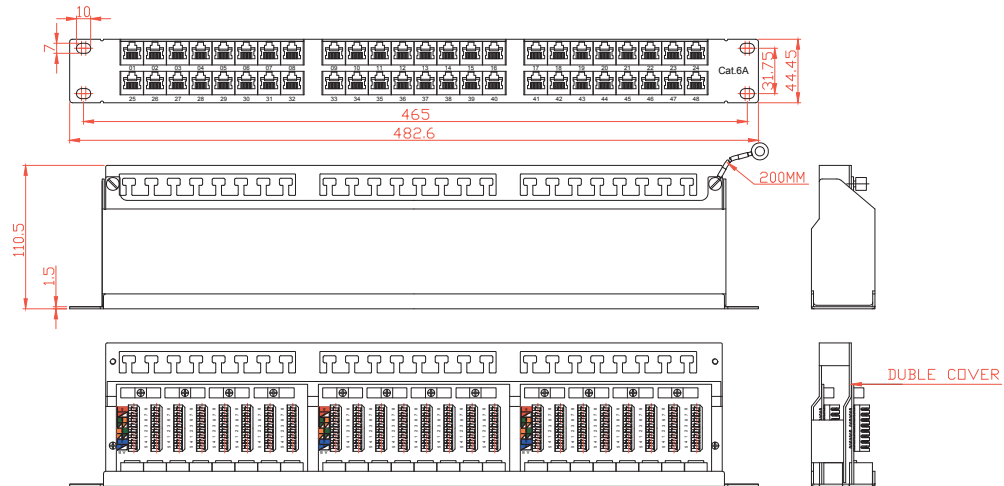

Specifications:

Electrical:

1. Voltage Rating: 125 VAC RMS
2. Current Rating: 1.5 AMP
3. Contact Resistance: 100 MILLIOHMS MAX
4. Insulation Resistance: 1000 MEGOHMS MIN @500 VDC
5. Dielectric Strength: 750 VAC RMS 60 Hz, 1MIN

Enviromental:

1. Storage: -40° to +85°
2. Operation: 0° to 70°

Mechanical:

1. Housing Material: PBT
2. Panel Frame: Carbon Steel, Powder, Coating in Black Color, Spcc 1.5mm
3. PBC Material: FR-4 T= 1.6mm
5. IDC Material: PC, Contact, Phosphor Bronze Nickel Pating
4. RJ45 Jack LIFE: 750 TIMES MIN
5. IDC Life: 200 TIMES MIN
6. Wire: AWG 22-26

Tolerance	
0. 00-20. 00	±0. 10
20. 00-50. 00	±0. 15
50. 00-100. 00	±0. 20
100. 00-	±0. 25
Angle	±30'

Notes

Angles Projection

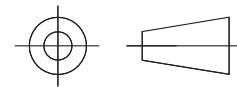

Size

A4

Scale

X:1

Unit

mm